

# ICR1254 B1 Datasheet

Rechargeable Lithium Ion Coin Cell 3.7 V

## Specifications

|                            |  |
|----------------------------|--|
| Renata Type                | ICR1254 B1                               |
| Nominal Voltage            | 3.7 V                                    |
| Nominal Capacity           | 72 mAh                                   |
| Minimum Capacity           | 68 mAh<br>( 0.2C cut off 3.0 V at 23°C ) |
| Internal Impedance Initial | < 500 mΩ appr. 1 kHz (60% SOC)           |
| Weight                     | ~ 1.6 g                                  |

## Dimensions

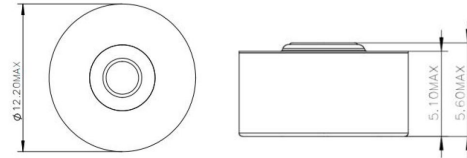

|                                |   |
|--------------------------------|---|
| <b>Charging Characteristic</b> | CC/CV – Constant Current / Constant Voltage |
| Voltage                        | 4.2 V                                       |
| Current Normal                 | 0.2 C CC – 13.6 mA                          |
| Cut-Off Current                | 0.05 C – 3.4 mA                             |
| Max. Charging Current          | 2.0 C CC – 136 mA                           |
| Temperature at Charging        | 0 °C .... 45 °C                             |

## Discharge Characteristic

|                                |  |
|--------------------------------|--|
| Cut-Off Voltage                | 3.0 V  |
| Max. Cont. Discharge Current   | 1.0 C – 68 mA                                |
| Temperature during Discharge   | -20 °C ... 60 °C                             |
| Cycle Life at Room Temperature | > 80% of minimum capacity after 1'000 cycles |

## Storage at SOC 30% SOC

|         |                |
|---------|----------------|
| 1 month | Up to - 55 °C  |
| 3 month | Up to - 45 °C  |
| 1 Year  | -20 to - 25 °C |

*Information and contents in this data sheet are for reference purpose only. They do not constitute any warranty or representation and are subject to change without notice. For most current information and further details, please contact your Renata representative. For safety related information please consult the ASDS document related to that product or product family. The Products of Renata SA are neither designed nor authorized for use in certain areas of application of environment. For further details we refer to our webpage [www.renata.com/downloads/restriction\\_of\\_use](http://www.renata.com/downloads/restriction_of_use)*