

# ICR1042 B4 Datasheet

Rechargeable Lithium Ion Coin Cell 3.85 V

## Specifications

Renata Type	ICR1042 B4
Nominal Voltage	3.85 V
Nominal Capacity	38 mAh
Minimum Capacity	36 mAh ( 0.2C cut off 3.0 V at 23°C )
Internal Impedance Initial	< 800 mΩ appr. 1 kHz (60% SOC)
Weight	~ 1.1 g

## Dimensions

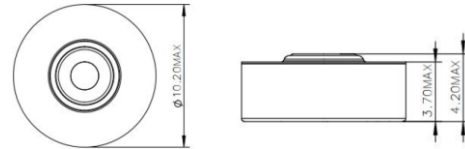

<b>Charging Characteristic</b>	CC/CV – Constant Current / Constant Voltage
Voltage	4.4 V
Current Normal	0.2 C CC – 7.2 mA
Cut-Off Current	0.05 C – 1.8 mA
Max. Charging Current	2.0 C CC – 72 mA
Temperature at Charging	0 °C .... 45 °C

## Discharge Characteristic

Cut-Off Voltage	3.0 V
Max. Cont. Discharge Current	1.0 C – 36 mA
Temperature during Discharge	-20 °C ... 60 °C
Cycle Life at Room Temperature	> 80% of minimum capacity after 1'000 cycles

## Storage at SOC 30% SOC

1 month	Up to - 55 °C
3 month	Up to - 45 °C
1 Year	-20 to - 25 °C

*Information and contents in this data sheet are for reference purpose only. They do not constitute any warranty or representation and are subject to change without notice. For most current information and further details, please contact your Renata representative. For safety related information please consult the ASDS document related to that product or product family. The Products of Renata SA are neither designed nor authorized for use in certain areas of application of environment. For further details we refer to our webpage [www.renata.com/downloads/restriction\\_of\\_use](http://www.renata.com/downloads/restriction_of_use)*